

SKETCH OF BEACH SHORE PROFILE SURVEY

A. R. TOUSSAINT & ASSOCIATES, INC.
 LAND SURVEYORS
 FLORIDA CERTIFICATE OF AUTHORIZATION No. LB-273
 620 N.E. 126 ST. NORTH MIAMI, FLORIDA 33161
 FB: 546 PGS: 1-62 DATE: JULY 06, 2009
 ORDER No. 14481 SCALE: 1" = 300'



VIRGINIA KEY BEACH PARK

BEAR CUT

RICKENBACKER

CAUSEWAY

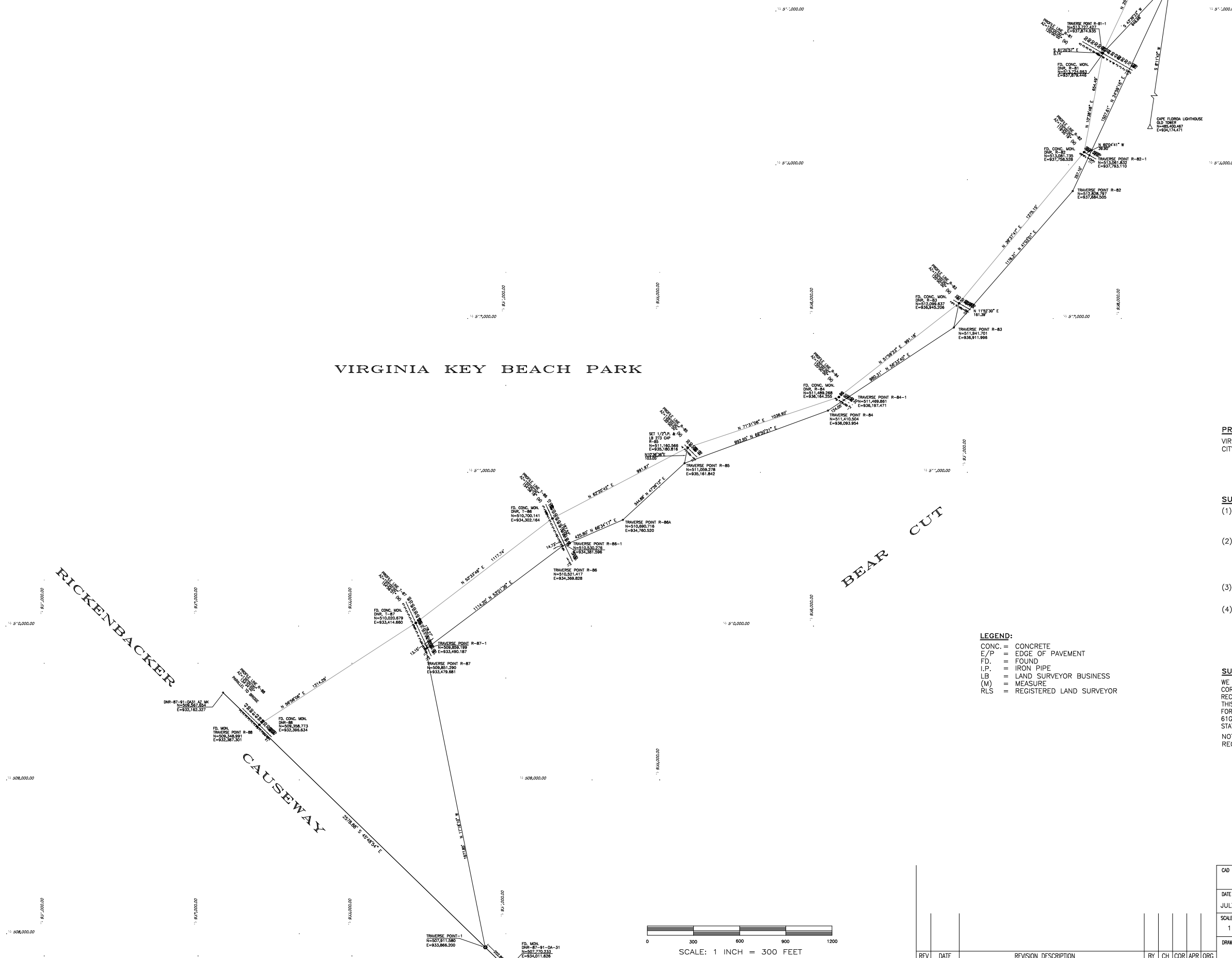

PREPARED FOR:
 VIRGINIA KEY BEACH PARK
 CITY OF MIAMI, FLORIDA

SURVEYOR'S NOTES

- (1) COORDINATES AND BEARINGS, REFER TO THE STATE PLANE COORDINATE SYSTEM, NORTH AMERICAN DATUM 1983/90, TRANSVERSE MERCATOR GRID, EAST ZONE, STATE OF FLORIDA.
- (2) COORDINATE SURVEY CONTROL BASED UPON, FDEP STATIONS D036 87-91-DA-28, D039 87-91-DA-31, D040 87-91-DA-31 AZ MK, NGS STATION CAPE FLORIDA LIGHTHOUSE OLD TOWER
- (3) ELEVATIONS SHOWN REFER TO THE NORTH AMERICAN VERTICAL DATUM, 1988. NAVD88.
- (4) SOURCE BENCH MARKS ARE MIAMI-DADE COUNTY, PUBLIC WORKS DEPARTMENT, SURVEY SECTION, BENCH MARKS BENCH MARK MI-6R ELEV=9.538, BENCH MARK KB-21 ELEV=5.655

LEGEND:

- CONC. = CONCRETE
- E/P = EDGE OF PAVEMENT
- FD. = FOUND
- I.P. = IRON PIPE
- LB = LAND SURVEYOR BUSINESS
- (M) = MEASURE
- RLS = REGISTERED LAND SURVEYOR

SURVEYOR'S CERTIFICATION:

WE HEREBY CERTIFY THAT THIS SKETCH OF SURVEY IS TRUE AND CORRECT TO THE BEST OF OUR KNOWLEDGE AND BELIEF AS RECENTLY SURVEYED AND PLATTED UNDER OUR DIRECTION AND THAT THIS SURVEY COMPLIES WITH THE MINIMUM TECHNICAL STANDARDS FOR LAND SURVEYING IN THE STATE OF FLORIDA, UNDER CHAPTER 61G17-6 FLORIDA ADMINISTRATIVE CODE, CHAPTER 472.027 FLORIDA STATUTES.

NOT VALID WITHOUT THE SIGNATURE AND RAISED SEAL OF THE REGISTERED LAND SURVEYOR SHOWN HEREON.

A.R. TOUSSAINT & ASSOCIATES, INC.

BY: _____ PRES.

ALBERT R. TOUSSAINT
 REGISTERED ENGINEER NO. 8939
 REGISTERED LAND SURVEYOR NO. 907
 STATE OF FLORIDA

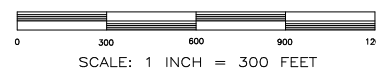

CAD FILE NAME		BEACH SHORE PROFILE SURVEY		BAR CODE
DATE	TITLE	PROFILE SURVEY VIRGINIA KEY BEACH PARK CITY OF MIAMI SECTION 16, 20, 21-54-42		
JULY 06, 2009				
SCALE	1" = 20'			
DRAWING NUMBER	SHEET	DRAWN BY:		
14481	1 OF 2	RS		
REV	DATE	REVISION DESCRIPTION	BY	CH COR APR ORG