

Miami-West Indies  
Archaeological Society



OLYMPIA HEIGHTS BRANCH

P. O. Box 53

MIAMI, FLA. 33165

SUPPLEMENTAL EXCAVATIONS AT THE ARCH CREEK SITE

by

Miami-West India Archaeological Society

&

Broward County Archaeological Society

Jack Erne, Field Director

Bert Mowers, Asst. Field Director

651-1906

SUPPLEMENTAL EXCAVATIONS AT THE ARCH CREEK SITE

DADE COUNTY by

MIAMI-WEST INDIA ARCHAEOLOGICAL SOCIETY

LOCATION: Sec. 28, Twn. 52S., Rng. 42E.

SITE RECORDED: DA-23. Dan D. Laxson, Hialeah, Florida

Supplemental Report: Arthur Marler, Broward Co. Archaeological Soc.

Occupation: Aboriginal indian site. Glades II to Glades IIIa periods.

Full ceramic and non-ceramic artifact records available from previous excavations.

Suggested salvage excavation on short term notice. 60 days.

Survey small area, avoiding areas previously excavated by Laxson and Marler. Set datum stake. Lay out one 5'x20' trench marked off in 5' squares, north-south. One trench 5'x20' marked off in 5' squares, east-west. Use arbitrary 6" levels. Excavate to bedrock or sand. Screen everything.

The excavating group must be allowed to place these trenches in such a manner as to avoid trees and tree roots to the best advantage. The trenches do not have to be contiguous.

An accurate account of the material excavated must be kept by LEVEL.

The Arch Creek Site is one of the last of the large aboriginal indian sites to fall before the wheels of progress. If it cannot be preserved in its entirety, at least preserve as full account as possible for the records.

Site records are kept at:

Division of Archives, History and Record Management, The Capitol  
Tallahassee, Florida 32304 Att. State Archaeologist.

The University of Florida, Gainesville, Fla. 32601

The Florida State Museum, Gainesville, Fla. 32601

Florida Atlantic University, Boca Raton, Fla.

## THE ARCH CREEK SITE

### Pit E-W, Unit #1

This pit is 5' x 10' and lies 3' north of an East-West line established on 4/16/72 by Bob Patton, Ted Huna, Jack Erne and others, and 10' west of the datum point.

The pit was supposed to furnish a good sample of the Indian artifacts present in the site, or at least to furnish some information about the site.

The screen was set up near the pit area, and screening of the dirt began. It was decided to dig in 6 inch levels, segregating the material found for counting and analysis.

LEVEL 1 (0-6") was completed on 4/16. After washing, drying and sorting, this level was found to contain 148 pottery sherds of which 1 was Dade Incised; 3 were unclassified wares (not local); 16 were Goodland Plain, (a Calusa, West Coast, ware); 2 were St. Johns Plain (a trade ware from North Florida); the rest were 126 Glades Plain, the usual home-made sand-tempered pottery of South Florida, or 85% of the total.

The non-ceramic artifacts found were: 5 shark vertebrae, 2 Strombus celts or scrapers; 1 Busycon gouge; 2 shell awls; 2 Columella tools; 8 worked Columella tips. The many food shells in various stages of disintegration were estimated at about 200 shells. Only shells that were obviously worked by grinding or chipping were counted.

The pottery found at this level was predominantly of Glades II age, so far as can be told, with possible dates from about 400 A.D. to 1250 A.D. No really old types were found, nor were any later types usually found in such sites. Specifically, no Glades Tooled, Surfside Incised, nor St. Johns Checkstamped sherds were found. The entire Glades III was missing. The conclusion can only be that this area had been bulldozed years ago, and the top layer completely removed. Therefore, we have a disturbed site, and that fact must be considered in our later judgements about the site.

LEVEL 2 (6"-12") Almost immediately stone was struck at numerous places across the pit. It was found that the stone (Miami Oolite) was composed of twisting ridges, with large holes between the ridges. This is quite typical surface rock in this area, a weathered, eroded surface pitted with "solution holes". Normal stratigraphic or level-digging was therefore out of the question.

Each hole was laboriously dug out with trowels, and the contents screened. At about 18" below the surface a clean brown sand barren of artifacts was encountered. Further digging yielded lighter sand but no more artifacts. So this level is really "6" to barren sand", and is so reported.

Level 2 yielded a total of 353 potsherds, distributed as follows: Key Largo Incised (3); Dade Incised (41); Unclassified Incised (3); Unclassified Wares (2); Goodland Plain (16); and Glades Plain (288), or 92.7% Glades Gritty Ware.

Non-ceramic artifacts found were: shark vertebrae (4); Strombus celt (1); Columella tools (2); Columella tips (16); worked shell (5); and Busycon tool (2).

The pottery found in this level was chronologically Glades II, little if any older than this in Level 1. This is disturbed strata.

However, the material at the bottom of these holes has not been disturbed. It is therefore assumed that this pottery must be the oldest pottery in this part of the site. At this time, one week after the beginning of excavations, we have not yet found any material that predates the previous excavations at this site.

NOTE: The "Dade Incised" pot was a mass of sherds found by Alice Cohen. Many pieces have been glued together into three sub-assemblies. More sherds may yet show up. This pot has a unique incision, probably a modification of Dade Incised. We call it "Alice's Pot", and it is the nearest thing to a restorable pot we have yet found.

Many food shells were found, many mere fragments. These unworked shells numbered 372.

After excavation of this pit, the Oolite was brushed throughly to reveal the topography, for photographic records.

The total ceramic artifacts found in this pit numbered 501, 90% of these being Glades Gritty Ware. The total non-ceramic artifacts found in this pit numbered 30.

THE ARCH CREEK SITE

Pit N-S, Unit #2

This is a 5' x 10' pit, 3' west of the North-South line through datum, and 8' north of datum. It was originally thought to be part of the best remaining area of the site for excavation, and is only a few feet from Unit #1.

LEVEL 1 (0-6"BS) After screening, washing, drying, and sorting this level was found to contain 56 pottery sherds of which there were: Key Largo Incised (1); Dade Incised (14); Ft. Drum Rim Pinched (1); Belle Glade Plain (1); Goodland Plain (3); and Glades Plain (including 2 rims and 34 body sherds), or 92.8% Glades Gritty Ware.

Non-ceramic artifacts found were: shark vertebrae (5); shark teeth (1); bone bi-points (1); Strombus celt (1); scraper (1); Busycon gouges and whole shell tools (9); Columella tool (1); Columella tips (6); and worked shell (1).

The recovered potsherds indicate generally Glades II age, essentially the same as Unit #1, previously reported. No late or early pottery found yet. Other artifacts agree with Glades II age.

LEVEL 2 (6" to Barren) Bedrock ridges came up into Level 1 at places. The stone was like that found in Unit #1. All material found in the solution holes was listed as Level 2, to barren sand.

In this level 203 sherds were found, as follows: Key Largo Incised (3); Miami Incised (18); Ft. Drum Rim Ticked (1); Ft. Drum Rim Punctated (3); Cane Patch Incised (1); Unclassified (9); Belle Glade Plain (2); Goodland Plain (11); St. Johns Plain (1); and Glades Plain (9 rims and 145 body sherds), or 93.1% Glades Gritty Ware.

Non-ceramic artifacts found were: shark vertebra (1); Strombus celt (1); Columella tools and tips (13); shell awl (1); shell pendant (1); and bone pin (1).

The Cane Patch Incised and Ft. Drum Rim decorated sherds may be slightly earlier than the Glades II date for Level 1. The Miami Incised pot is a variant with 2 incised patterns. One is a conventional Miami Incised 5-line diagonal pattern, but the other incising is similar to the unique incising on "Alice's Pot" from Unit #1. This pot is partially restored.

The "Unclassified Incised" pot has a highly unusual 5-stacked curves incising, like Opa-Locka Incised, but upside down. Could it have been stamped with the stamping tool reversed?

After excavation of this pit, it was brushed thoroughly to reveal the topography, for photographic records.

THE ARCH CREEK SITE

Pit E-W, Unit #3

This pit is an extension of Unit #1 for 10' to the west. The procedures followed were the same as in Unit #1.

LEVEL 1 (0-6") This level yielded a total of 198 potsherds, distributed as follows: St. Johns Checkstamped (2); Key Largo Incised (11); Dade Incised (4); Miami Incised (1); Belle Glade Plain (4); Goodland Plain (13); and Glades Plain (9 rims and 154 body sherds), or 90.4% Glades Gritty Ware.

Non-ceramic artifacts found were: shark vertebrae (16); bone bi-points (2); Strombus celts and scrapers (3); Busycon tool (1); Columella tools (6); Columella tips (12); and worked shell (gouges, etc.) (6).

The sherds in this level were generally of Glades II age. However, 2 Glades III sherds were also recovered.

LEVEL 2 (6" to Barren) In this level a total of 232 sherds were collected, distributed as follows: Key Largo Incised (1); Miami Incised (6); Ft. Drum Punctated (8); Goodland Plain (29); and Glades Plain (21 rims and 167 body sherds), or 87.5% of Glades Gritty Ware.

Non-ceramic artifacts found were: shark vertebrae (2); Strombus celt (1); Busycon tools (6); Columella tips (22); and worked shell (6).

The sherds in this level were of Glades II age.

In this pit were recovered the first St. Johns Checkstamped sherds found during this excavation. This sherd is a Glades III type, and proves that the site originally had a later component than our present findings would seem to indicate. Presumably, this component was removed by bulldozing back in the 1930's-40's. Nothing was found in Unit #3 to contradict the statements made for Units #1 and #2.

Total potsherds for this pit numbered 430 pieces.



THE ARCH CREEK SITE

4/16-18/72

BM

SHELL

PIT N-S-UNIT #2, LEVEL-1 (0-6")

"ACNS21A"

STROMBUS CELT



11.5 CM LONG  
6 CM WIDE  
1.5 CM THICK

BROWN PATINA  
IN DEPRESSIONS  
OTHERWISE WHITE,  
SOFT, ERODED

← GROUND EDGE

LIGHT, THIN CELT - AXE.

-1 pc

SCRAPERS

2 THIN, ERODED FRAGMENTS  
PROBABLE ARTIFACTS

SHELL UNIDENT.

-2 pc

ROUGES - POOR CONDITION, BUT BROKEN PRETTY OBVIOUSLY

LARGE -

-4 pc

SMALL

-2

COLUMELLA TOOLS, LONG, POINTED

-1

SHORT TIPS, BROKEN TO POINTS - LARGER

-4

BUSYCON WHELK SHELLS - POSSIBLE ARTIFACT - MED.

-2

-3

<sup>LONG</sup>  
THIN SECTION WHELK SHELL - NAT. BREAK. - ?

-1

TOTAL

20 ~~7~~ pc

NOTE - MANY LARGE SHELLS & FRAGMENTS NOT SAVED - NOT VISIBLY WORKED - ABOUT 50 THIS LEVEL



THE ARCH CREEK SITE

DUG 4/16-18/72



BH

PIT - N-S - UNIT #2, LEVEL - 1 (0-6")

MODERN ARTIFACTS

METAL - LARGE FLAT MASS, PROBABLY RUSTY SHEET IRON	- 1 pc
1" DISC.	- 1
CAST IRON, (BRAKE SHOE FOUND IN UNIT 1)	- 1
SCRAP LEAD, MELTED BLOB, FLAT 1/2 oz.	- 1
GLASS - BLUE BUTTON, MOLD'D GLASS 4MM DIAM NOT TRADITION	- 1 pc
ASSORTED FRAGMENTS GLASS BOTTLES, BLUE BROWN, WHITE	- 3
FLAT GLASS, BLUE WITH PAINTED AREAS	- 2
	- 3 pc
TILE - GRAY WALL TILE	- 1
TARRED ROOFING BUILD-UP	- 1
CEMENT TILE (ROOF) FRAGMENT	- 3
SEWER TILE	- 1
	TOTAL 18 pc

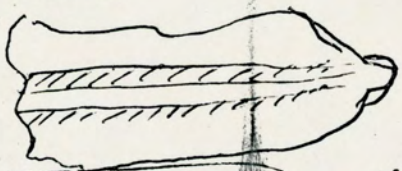
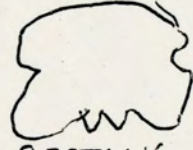
BONE / - SHARK VERTEBRAE LARGE	- 2
SMALL	- 3
" TOOTH	- 1
TURTLE "L" - BONE FRAG.	- 1
BONE POINT TIP FRAGMENT	
TIP SCORCHED IN FIRE 1.5 CM LONG	- 1 pc
GROUND & POLISHED	
	TOTAL 8 pc

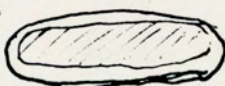
WOOD - SEED - LARGE - SP ?		SEEN BEFORE, NOT IDENTIFIED	- 1 pc
3.2 cm h 1.5 cm w			
SEED - SMALL		SECTION VERY SMOOTH POLISHED HARD, UNIFORMLY COLORED LT. COL. EDGE, BROWN CENTER	- 3 pc
			
CHARCOAL - 1/2 LUMP			- 1 pc
WOOD & BONE PACKED TOGETHER PLASTIC BOTTLE			5 pc
			+ 13 pc

THE ARCH CREEK SITE

BUG 4/16-18/72

BM

PIT N-S - UNIT #2 - LEVEL-1

(0-6")

POTTERY

POT #1 - GGW

DARK DIRTY TAN-GRAY IS; SMOKE PARKER OS.

KEYLARGO INCISED

1 RIM



INT. TAN WITH BLACKISH CORE (15%)

BEACH SAND TEMPER

EVERTED LIP? -

(MUCH LIKE GOODLAND(?)  
NOT-HARD BAKED LATE GGW)

POT #2 NOT GGW

BELLEGLACK PLAIN

1 BS

1 BS. LARGE, THIN WARE, ROUGH SCRATCHED O.S. THIS SURFACE  
LT. GRAY IS, SMOKE PARKER OS. - 4-6 MM. VERY HARD, DENSE  
FINE SAND TEMPER, - INT. BANNED GRAYS

POT #3 GGW

MED. GRAY IS + OS

FT. DRUM

RIM-PINCHED

1 RIM

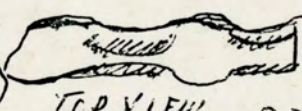
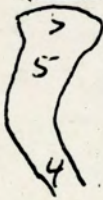

ALSO INT.

FAIRLY SOFT, HOMOG.

TOP VIEW BEACH SAND TEMPERED

OUTSIDE VIEW THIS MIGHT BE CALLED GLADES TOILED BUT THE WARE IS  
DEFINITELY NOT LATE " " BUT EARLY BEACH SAND  
TEMPERED STUFF

POT #4 GGW

DADE INCISED

2 DEC. BS.

12 BS.

6-8 MM. T.

14



MED. TAN-GRAY INSIDE  
SMOKE MUCH DARKER OUTSIDE  
SOFT OPEN-TEXTURED, BLACK CORE WITH  
THICK LIGHTER SKINS, ESPECIALLY I.S.  
SAND TEMPERED

3 INSCRIBED LINES, LOOPS OPEN AT TOP.

WATCH FOR MORE OF THIS POT. —

POT #5 GGW

GLADES PLAIN

2 RIMS

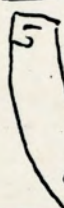

DIRTY DARK BROWN GRAY IS + OS  
" " " INT.  
SOFT, OPEN-TEXTURED, SAND TEMPERED

6.5 NO DEC.

Misc. BODY SHEARDS POT #6

GOODLAND PLAIN -

3 PC

Misc. " " "

GLADES PLAIN -

34 PC

ARCH CREEK SITE

DUG 4/16-18/72

PM

PIT N-S, UNIT #2, LEVEL-2 (6" TO BARRIN)

POTTERY

LARGE SHARDS, FOUND IN 1 SMALL AREA, KPTS SEPARATED FOR POSSIBLE RESTORATION "BOB KORMAN'S POT".

POT #1 GGW

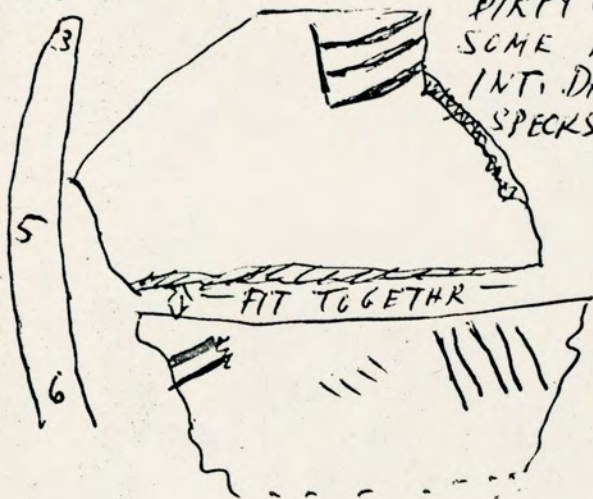

DIRTY GRAY IS+OS, SMOCKED DARKER  
SOME PINKISH BLOSS  
INT. DK. BROWN GRAY, DENSE, HARD  
SPECKS IN PASTE; - SAND TEMPERED

VERY LARGE DIAM. POT, IN TURNED RIM  
16-18" DIAM. APERTURE  
(10 PR. GLUED TOGETHER)  
(3 SUB ASSEMBLIES)

MIAMI INCISED  
VARIANT

2 RIMS

13 BS

15 PC

POT #2 - GGW

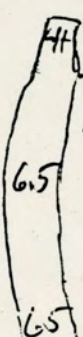

MED. TAN BROWN OUTSIDE + INSIDE, BUT SMOCKED BADLY IN SPOTS  
INT. - CRANOR TAN, SOME BLACKISH CORE AT LIP.  
BEACH SAND TEMPER  
STRONG GOODLAND TENDENCIES

NO DEC.

~~6 PR. GLUED TOGETHER~~

GLADES PLAIN

1 RIM

1 BS

~~2 RIM~~  
~~8 BS~~  
~~10 PC~~

POT #3 NOT GGW

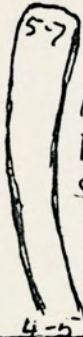

MED. LIGHT PINKY-BEIGE, WITH DARKER CLOUDED AREAS,  
OS + IS, SCRATCHES AROUND SURFACES, HORIZONTAL  
INT. LT GRAY, WITH LIGHTER TAN 'SKINS', ESP. OS.  
VERY DENSE, QUITE HARD, <sup>SOME</sup> FINE SAND TEMPER  
SOME VOIDS IN PASTE

NO DEC.

MUCH THE LIGHTEST COLOR B.G.P. I HAVE SEEN:

18" DIAM. APERTURE

BELLE GLADE PLAIN

1 LARGE RIM

1 BS

2 PC

POT #4 GGW

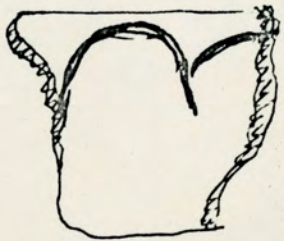
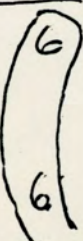

DARK BROWN-GRAY OS, SMOCKED DARKER IS.  
INT. SOFT, BLACKISH CORE WITH TAN OS. SKIN  
FINE SAND TEMPER

KEYLARGO/INCISED

3 RIMS

MORE?

OTHER MATERIALS

SIT N-S, UNIT #2, LEVEL 2, (6<sup>th</sup> PC BARRICA)

BONE - SHARK VERTEBRA	SMALL PERFORATED	-	1 PC
PEARL BONE SLIP	PC - NOT WORKED	-	1
MISC BONE BITS NOT IDENT.	" "	-	5
TURTLE SHELL "	" "	-	5
LIMB BONE, SMALL MAMMAL, NOT IDENT.		-	1
FULL FISH VERTEBRA	-	2	
	TOTAL		15 PC

MODERN ARTIFACTS - CAST IRON (BRAKESHOE?) 3<sup>rd</sup> - 1 PC

NAILS, VERY RUSTY		3
MIRROR GLASS FRAG.		-1
ROOFING TAR - CHUNK 1 1/2"		-1
SEWER TILE		-1
TILE FRAG. GLAZED		-1
CHARCOAL - 3 SMALL BITS		-3
BUTTON - WHITE PLASTIC		-1
	TOTAL	12 PC

SHELL - SOFT WHITE ERODED PENDANT-SHAPED OBJECT "ACNS22A" - 1 PC



3.3 CM L X 1 CM DIAM.  
TRACE OF GROOVE VISIBLE - BARELY ERODED

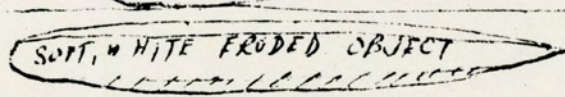

SOFT, WHITE ERODED OBJECT  
NO WORKED MARKS VISIBLE  
5.3 CM L X .8 CM W



SOFT WHITE ERODED  
FLATTISH OBJECT. NO WORKED MARKS VISIBLE  
4 X 3 CM.

STROMBILUS GILT FRAGMENTS WHICH MAY BE BURN SCORCHED  
IN FIRE, AND ARE VERY FRAGILE

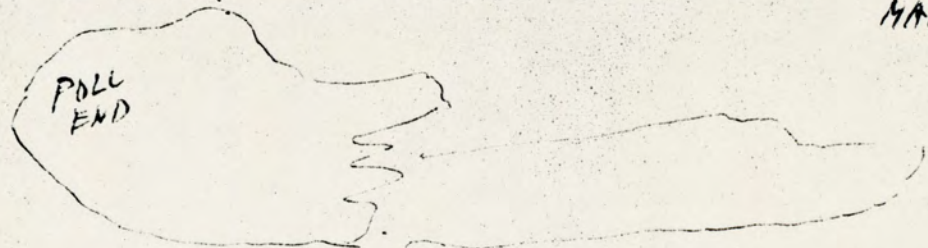

MANY THIN PCS -

2 MORE VERY ERODED NON DESCRIPT OBJECTS, (?)  
ALL PACKED AS "ACNS22A"

SMALL TIPS & GOUGES, SIMILAR DESCRIPTIONS, UNDER 5 CM.	-	15 PC
LARGER " " " "	5-7 CM. LONG -	9
" " " "	7-10	5
WHOLE SHELL TOOLS, SMALLER, BUSYARD ETC. WORKED TIPS (?)	-	13
SMALL SCOWS, LADLES, SPOON-LIKE & GOUGE-LIKE BITS, ABOUT SAME DESCRIPTION	-	7
COLUMELLA TOOLS, LIKE AWLS OR PUNCHES ASSORTED	-	3
	TOTAL SAID -	72 PC

+ ABOUT 25 ASSORTED FISH SHELLS, ALL STAGES OF PINNACULATION 75+

ALL SHELLS IN ONE PLASTIC BAG - 142 (?)

U 51

El - 4.55

N.E. 135 51

EL. 2.25 UNIT

5

DATUM

EL. 2.40

EL. 2.55

EL. 2.1 UNIT

5 A

EL. 3.00

UNIT

DATUM

UNIT UNIT  
1 3



N

ARCUT CRACK

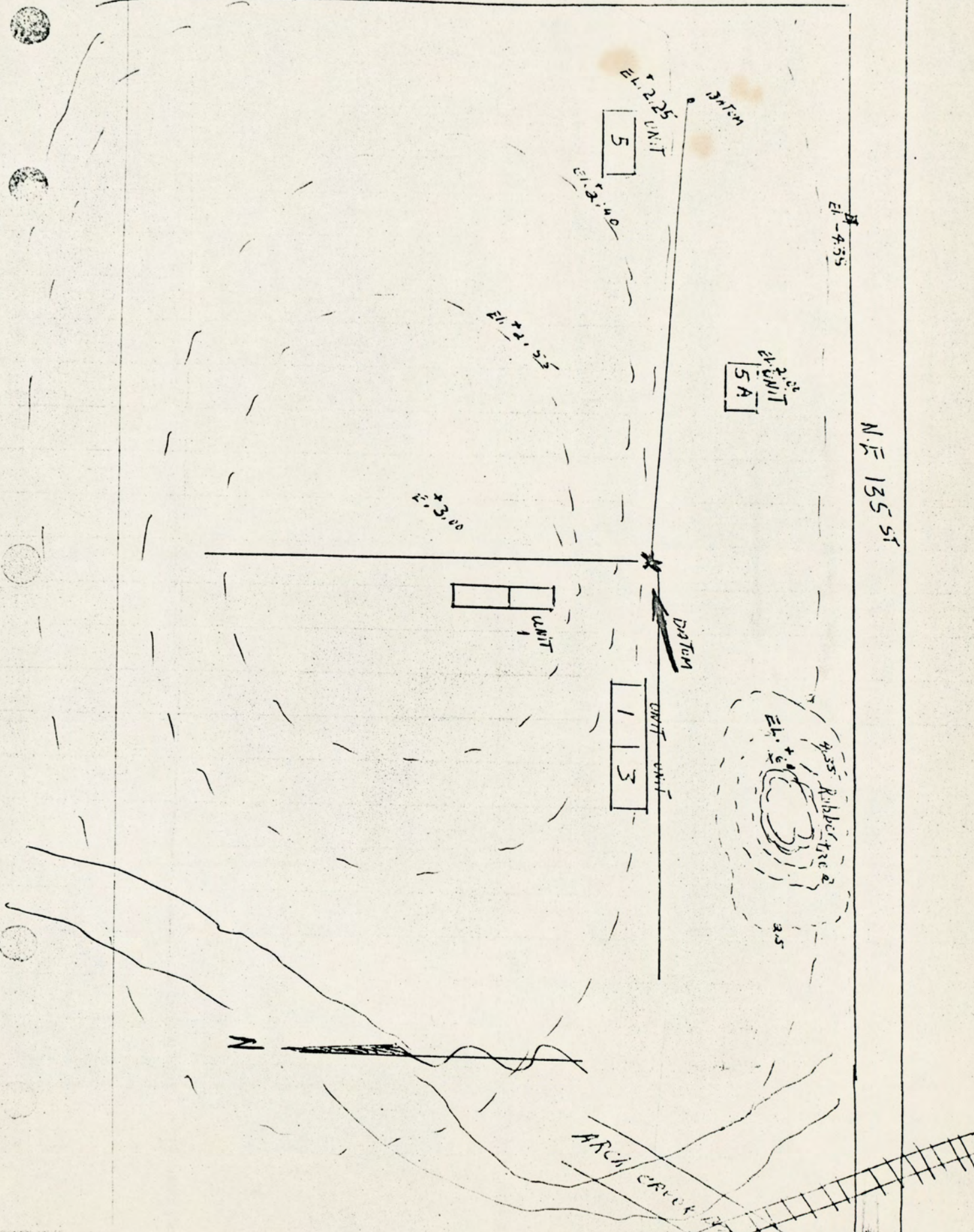

COMMENTS

The Miami-West India Archaeological Society and the Broward County Archaeological Society extend their appreciation to Chrysler Corporation for the privilege of excavating at the Arch Creek Site for 60 days.

Because of the lack of depth in the present pits we need to extend our range of excavations at least 200 sq. ft. in 5' x 20' ft. pits. It is hoped that by so doing we will be able to find evidence which will significantly push back the age of site occupation.

Vandalism and pilferage have occurred at this site, but they are minimal. It is hoped that roped barriers erected by the Field Director will prevent any further occurrence of this nature at this site.

Excavations are proceeding as planned. Each day's digging reveals more and more of the life style of these fascinating people, the Tequesta Indians.

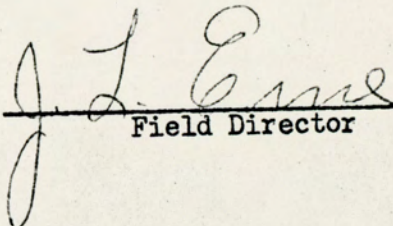
  
Field Director

Submitted by:

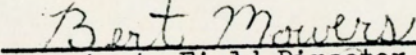
  
Asst. Field Director

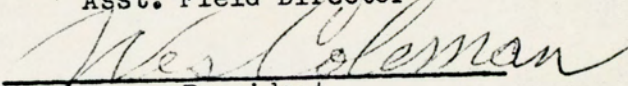
  
President

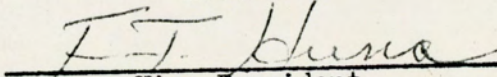
  
Vice President

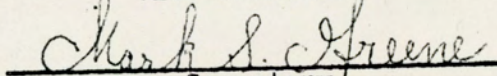
  
Secretary

PEOPLE IN ATTENDANCE AT

ARCH CREEK SITE DIG

4/23/72

Jack L. Erne  
16100 N.W. 27th Ct.  
Opa-Locka

Mark S. Greene  
109 San Sebastian Ave.  
Coral Gables

Evilyn Rubin  
19620 N.E. 18th Ct.  
North Miami Beach

Bob Gorman  
615 85th Street  
Miami Beach

Lee Minich  
13060 Keystone Terrace  
Hollywood

Dorothy Mowers  
2313 Monroe Street  
Hollywood

Bert Mowers  
2313 Monroe Street  
Hollywood

Lorraine W. Vagner  
2201 Brickell Ave.  
Miami

Carol W. Hard  
1710 N.E. 138th St.  
North Miami Beach

F. T. Huna  
3031 N.W. 171st St.  
Opa-Locka

Jim McLellan  
1665 W. 76th St.  
Hialeah

John Paip  
3835 N.W. 168th St.  
North Miami Beach

Jim Patton  
5901 Banyan Terrace  
Plantation

Robert H. Patton  
5901 Banyan Terrace  
Plantation

Kipp White  
2041 Sunset Strip  
Hollywood

Marvin H. LeVine  
2585 So. Bayshore Dr.  
Miami

Wilma Williams  
2511 McKinley Street  
Hollywood

Wesley F. Coleman  
10 N.W. 127th Avenue  
Sweetwater