

FLORIDA MASTER SITE FILE
 Site Inventory Form

FDAHRM 802 ==
 1009 ==

Site Name _____ Site No. 830 == Survey Date 8506 820 ==
 Address of Site: 83 N.E. 100 Street, Miami Shores, Fl. 905 ==
 Instruction for locating on N side of NE 100 St. between N. Miami Ave
and NE 1 Avenue 813 ==
 Location: Miami Shores Sec. 1 Amd. 10 block no. E 1/2 of 21 & all 22 lot no. 868 ==
 County: Dade 808 ==
 Owner of Site: Name: Pahl, Michael ;
 Address: 83 N.E. 100 St., Miami Shores, Fl. 902 ==
 Type of Ownership private 848 == Recording Date _____ 832 ==
 Recorder:
 Name & Title: Newton, Margo (Chair); Stofik, Marty ;
 Address: MSHPB

Condition of Site: Integrity of Site: Original Use private residence 818 ==
 Check One Check One or More Present Use private residence 850 ==
 Excellent 863 == Altered 858 == Dates: Beginning +1925 844 ==
 Good 863 == Unaltered 858 == Culture/Phase American 840 ==
 Fair 863 == Original Site 858 == Period 20th Century 845 ==
 Deteriorated 863 == Restored() (Date: X) 858 ==
 Moved() (Date: X) 858 ==

NR Classification Category: Building 916 ==

Threats to Site:

Check One or More
 Zoning(X) 878 == Transportation(X) 878 ==
 Development(X) 878 == Fill(X) 878 ==
 Deterioration(X) 878 == Dredge(X) 878 ==
 Borrowing(X) 878 ==
 Other (See Remarks Below): 878 ==

Areas of Significance: Architecture 910 ==

Significance:
 Structure is an excellent example of Mediterranean Revival architecture adapted to a one-story residence. It was built during the first year of the Shoreland Company's development of Miami Shores. Noteworthy features include a 1½-story entry tower and entrance door flanked by twisted columns of Corinthian influence. Structure is in scale and character with surrounding neighborhood.

911 ==

ARCHITECT Tropical Home Designs (Miami, FL) 872 ==
 BUILDER Tropical Home Designs (Miami, FL) 874 ==
 STYLE AND/OR PERIOD Mediterranean Revival 964 ==
 PLAN TYPE irregular; irregular 966 ==
 EXTERIOR FABRIC(S) stucco: rough 854 ==
 STRUCTURAL SYSTEM(S) masonry: concrete block 856 ==
 PORCHES S/ entry terrace, open with low wall, access
from S 942 ==
 FOUNDATION: concrete block 942 ==
 ROOFTYPE: flat, with parapet 942 ==
 SECONDARY ROOF STRUCTURE(S): tower# hip#flat#shed 942 ==
 CHIMNEY LOCATION: E: end, exterior 942 ==
 WINDOW TYPE: awning, metal # fixed 942 ==
 CHIMNEY: concrete block 882 ==
 ROOF SURFACING: tile: flat, tar and gravel 882 ==
 ORNAMENT EXTERIOR: masonry 882 ==
 NO. OF CHIMNEYS 1 952 == NO. OF STORIES 1 950 ==
 NO. OF DORMERS none 954 ==
 Map Reference (incl. scale & date) Miami Shores Village Plat 1980
 809 ==
 Latitude and Longitude: " " " " " " 800 ==
 Site Size (Approx. Acreage of Property): LT 1 833 ==

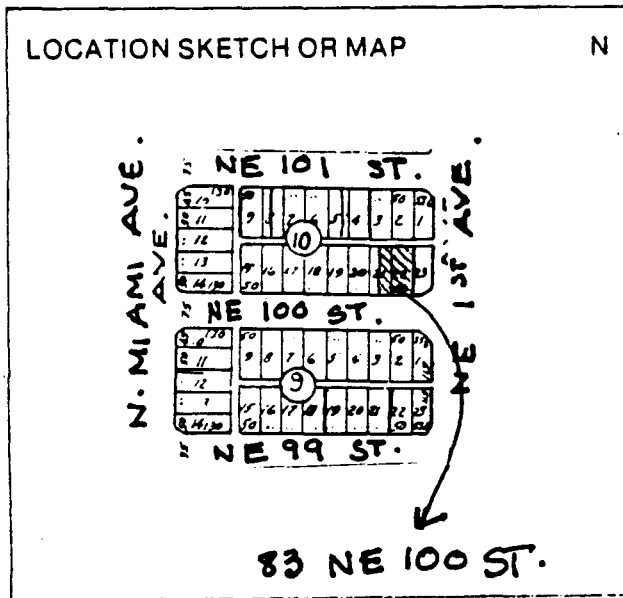

Township	Range	Section	
53S	R41E	S1	812 ==

UTM Coordinates:
 Zone Easting Northing 890 ==

Photographic Records Numbers 85N111HG21A/85N111HG23A 860 ==

Contact Print



CONTINUATION SHEET

Physical Description:

Structure is a one-story Mediterranean Revival residence. A 1½-story entry tower on SE has masonry cartouche above entry door. Door is flanked by twisted columns of Corinthian influence and is arched. Enclosed 5-bay porch on SW has twisted columns separating enclosed window bays. Sculpted buttress on E structural corner.

MSHPB USE ONLY

sandblasted ext. '83

MIAMI SHORES, FL



E.E. OLIVER SUB.

TRACT A
PD. 43-48
ST. ROSE OF LIMA
SCHOOL & CHURCH

MIAMI LAKES
LAKE

MIAMI SHORES
ELEMENTARY
SCHOOL

NE 100th St

CONCOURSE
GRAND