

FLORIDA MASTER SITE FILE  
 Site Inventory Form

FDAHRM 802 ==  
 1009 ==

Site Name \_\_\_\_\_ Site No. \_\_\_\_\_  
 830 == Survey Date 8506 820 ==  
 Address of Site: 34 NW 96 St., Miami Shores, FL 905 ==  
 Instruction for locating on S side of NW 96 St. between N. Miami Avenue  
 and NW 1st Ave. 813 ==  
 Location: Miami Shores Sec. 6 131 7 & E 25' of 8 868 ==  
subdivision name block no. lot no.  
 County: Dade 808 ==  
 Owner of Site: Name: Pickard, G.S. ;  
 Address: 34 NW 96 St.  
 Miami Shores, FL 902 ==  
 Type of Ownership private 848 == Recording Date 832 ==  
 Recorder:  
 Name & Title: Stofik, Marty & Newton, Margo (Chair) ;  
 Address: MSHPB

Condition of Site: Integrity of Site: Original Use private residence 818 ==  
 838 ==  
 Check One Check One or More Present Use private residence 850 ==  
 Excellent 863 ==  Altered 858 == Dates: Beginning +1928 844 ==  
 Good 863 ==  Unaltered 858 == Culture/Phase American 840 ==  
 Fair 863 ==  Original Site 858 == Period 20th Century 845 ==  
 Deteriorated 863 ==  Restored ( ) (Date: ) 858 ==  
 Moved ( ) (Date: ) 858 ==

NR Classification Category: Building 916 ==

Threats to Site: None  
 Check One or More  
 Zoning ( ) ( ) 878 ==  Transportation ( ) ( ) 878 ==  
 Development ( ) ( ) 878 ==  Fill ( ) ( ) 878 ==  
 Deterioration ( ) ( ) 878 ==  Dredge ( ) ( ) 878 ==  
 Borrowing ( ) ( ) 878 ==  
 Other (See Remarks Below): 878 ==

Areas of Significance: Architecture 910 ==

Significance:  
 Structure was built during second phase of Miami Shores' development under the New Miami Shores Company. Architect, Robert Law Weed, was one of architects responsible for the architectural theme of Miami Shores, particularly the Mediterranean Revival style. Noteworthy features include the 1½ story living room central mass and the arched bay porch on E. Structure is in scale and character with surrounding area.

911 ==

CONTINUATION SHEET

Physical Description:

Structure is Mediterranean Revival style residence. A 1½-story central mass houses high-ceilings living room. One-story wings extend E,W and S. All have gable barrel tile roof. Porch on E end has arched bays on N and S and three arched bays on E. Arches are fitted with latticework. Chimney mass on N facade extends upward from mid-window level.

MSHPB USE ONLY

Addition 1945  
Denn added 1954

ARCHITECT Weed, Robert Law (Miami, FL) 872 ==  
 BUILDER Home Builders Construction Co. (Miami, FL) 874 ==  
 STYLE AND/OR PERIOD Mediterranean Revival 964 ==  
 PLAN TYPE central mass with asymmetrical wings 966 ==  
 EXTERIOR FABRIC(S) smooth stucco 854 ==  
 STRUCTURAL SYSTEM(S) concrete block 856 ==  
 PORCHES E; screened, 3 E bays, 1N, 1S, access W  
 942 ==  
 FOUNDATION: concrete block 942 ==  
 ROOF TYPE: -multiple gable 942 ==  
 SECONDARY ROOF STRUCTURE(S): gable 942 ==  
 CHIMNEY LOCATION: N: end, ext. 942 ==  
 WINDOW TYPE: wood casement 942 ==  
 CHIMNEY: CBS 882 ==  
 ROOF SURFACING: barrel tile 882 ==  
 ORNAMENT EXTERIOR: none 882 ==  
 NO. OF CHIMNEYS one 952 == NO. OF STORIES one 950 ==  
 NO. OF DORMERS none 954 ==  
 Map Reference (incl. scale & date) Miami Shores Village Plat 1980 809 ==  
 Latitude and Longitude: " " " " 800 ==  
 Site Size (Approx. Acreage of Property): LT1 833 ==

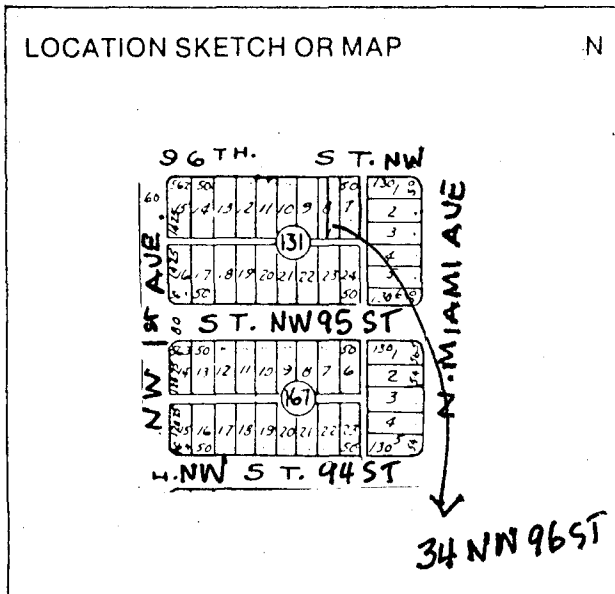

Township	Range	Section
53S	41E	1

UTM Coordinates:

Zone Easting Northing 890 ==

Photographic Records Numbers 85N107HG34/85N107HG35 860 ==

Contact Print

