

TAMIAMI PINES PARK 29.

POST WAR PLANS

DEVELOP AS A MAJOR LEAGUE BASEBALL FIELD.

GRANDSTAND, ADMINISTRATIVE OFFICES, LOCKERS, DRESSING ROOMS,
BROADCASTING BOOTHS, PRESS BOX AND LUNCH ROOM.

PARKING LOTS.

WALLED-IN BASEBALL DIAMOND.

FLOODLIGHT TOWERS.

LANDSCAPING AND SHADE TREES.

CHAIN LINK BOUNDARY LINE FENCE.

SKETCHES FOR THIS PROJECT COMPLETED.

(SEE "POLICING" UNDER MIAMI DIVISION OF PARK POLICE)

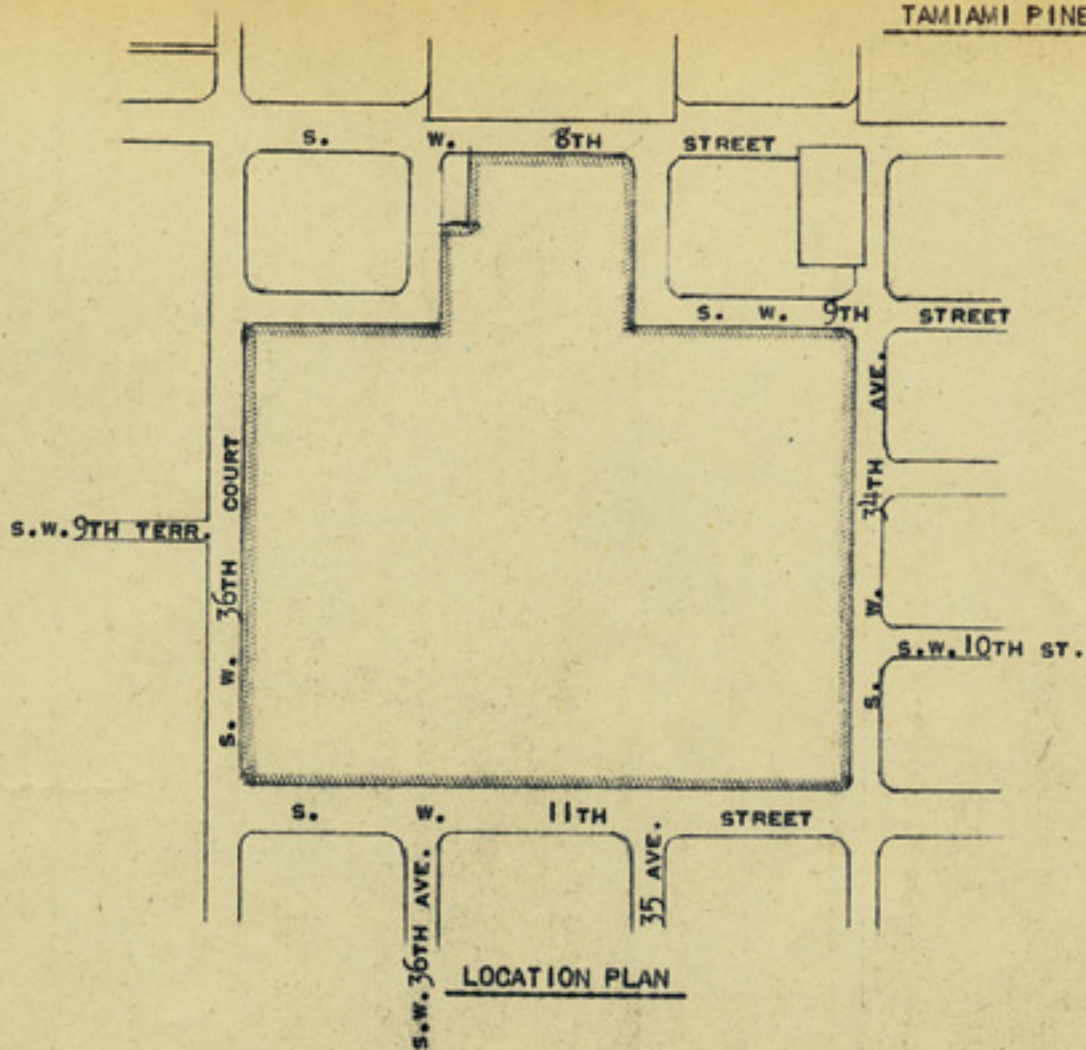

10.0 ACRES
UNDEVELOPED PLAYFIELD
THIS AREA HAS BEEN PROPOSED FOR
LEAGUE BASEBALL DIAMOND