

RODDEY BURDINE STADIUM 33.

POST WAR PLANS

ACQUIRE ADDITIONAL PROPERTY AS HEREIN DESCRIBED:

LOTS 13, 14, 15, 16, 18, 19 AND 20, BLOCK 33

LOTS 3, 4, 7, 9, 10, 11 AND
NORTH 50' OF LOT 12,
LOTS 14 AND 15
ALL OF BLOCK 34

LOTS 5, 6, 7, BLOCK 37

LOTS 1 AND 2, BLOCK 38

ALL OF LAWRENCE ESTATE LAND CO.'S SUBDIVISION.

CLOSE N. W. 6TH STREET BETWEEN N. W. 14TH TO 16TH AVENUES;
ALSO N. W. 15TH AVENUE BETWEEN N. W. 6TH TO 7TH STREETS.

ERECT A 6' HIGH CHAIN LINK BOUNDARY LINE FENCE AROUND THE
WHOLE AREA.

DEVELOP AS A PARKING AREA.

LANDSCAPING AND SHADE TREES.

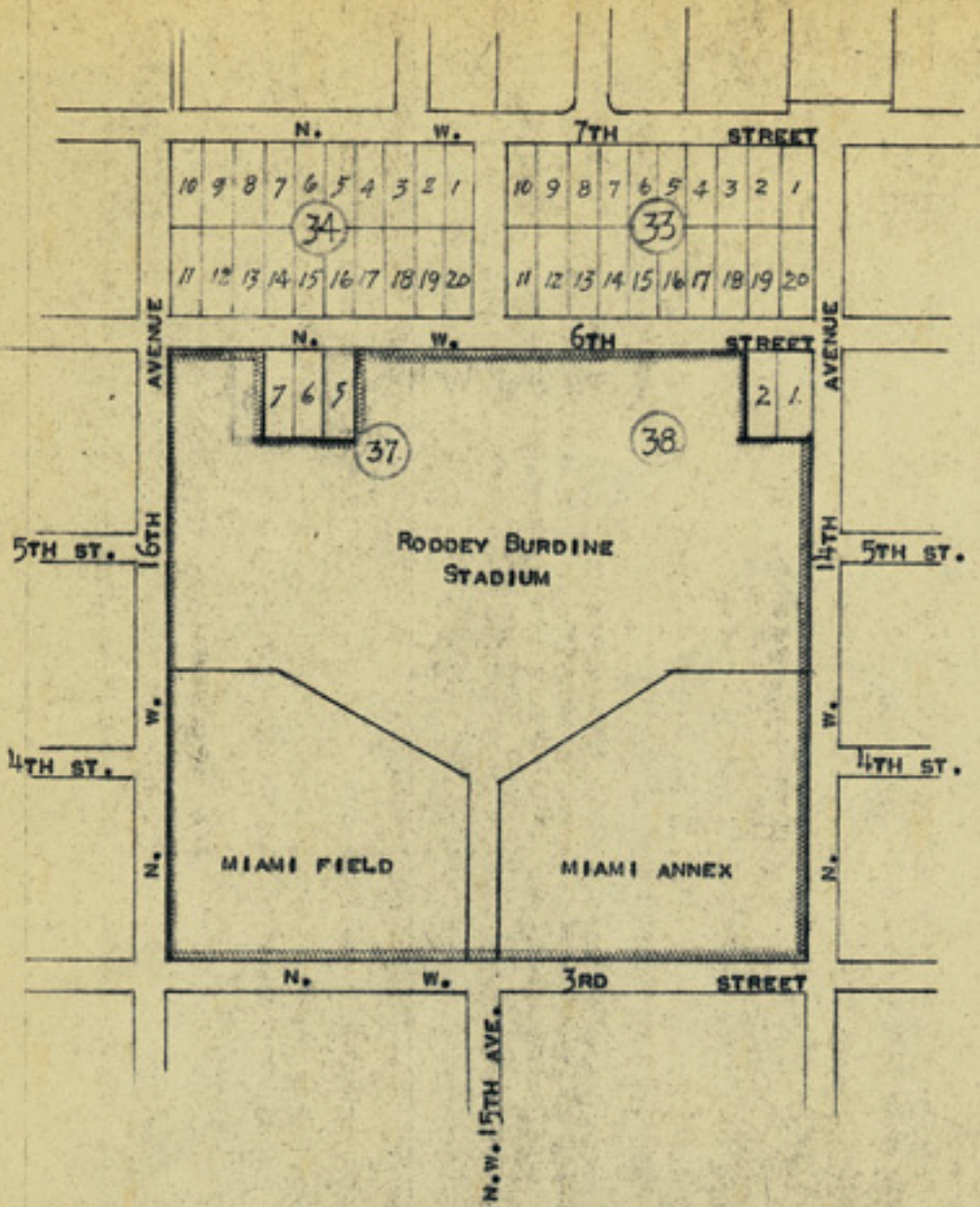

LOCATION PLAN