

HIGHLAND PARK 16.

POST WAR PLANS

ACQUIRE ADDITIONAL PROPERTY FROM THE NORTH BOUNDARY LINE NORTH TO N. W. 20TH STREET AND FROM N. W. 8TH AVENUE EAST TO N. W. 10TH AVENUE, ADDING ABOUT FIVE ACRES TO THE PRESENT PARK.

BUILD A NEW COMMUNITY BUILDING WITH LIBRARY, OFFICE AND REST ROOMS.

BANDSTAND, OPEN AIR THEATRE AND RAIN SHELTERS.

A BATTERY OF 20 SHUFFLEBOARD COURTS.

MODERNIZE EXISTING REST ROOMS, OFFICE AND SHELTERS IN RECREATION AREA.

BRING ENTIRE AREA UP TO STREET GRADE BY FILLING WITH ASHES FROM INCINERATOR.

TOPSOIL AND LANDSCAPE, ADDING SHADE TREES WHERE NECESSARY.

RESURFACE EXISTING TENNIS COURTS AND BASKETBALL COURTS.

ERECT CHAIN LINK TENNIS COURT BACKSTOPS AND CONTINUE CHAIN LINK FENCE AROUND NEWLY ACQUIRED AREA ON THE NORTH.

CONSTRUCT A BASEBALL DIAMOND AND SOFTBALL DIAMOND COMPLETE WITH CHAIN LINK BACKSTOPS.

INSTALL A COMPLETE SPRINKLER SYSTEM, A FLOODLIGHTING SYSTEM FOR THE WHOLE AREA.

INSTALL ADDITIONAL APPARATUS IN CHILDREN'S AREA.

(SEE "POLICING" UNDER MIAMI DIVISION OF PARK POLICE)

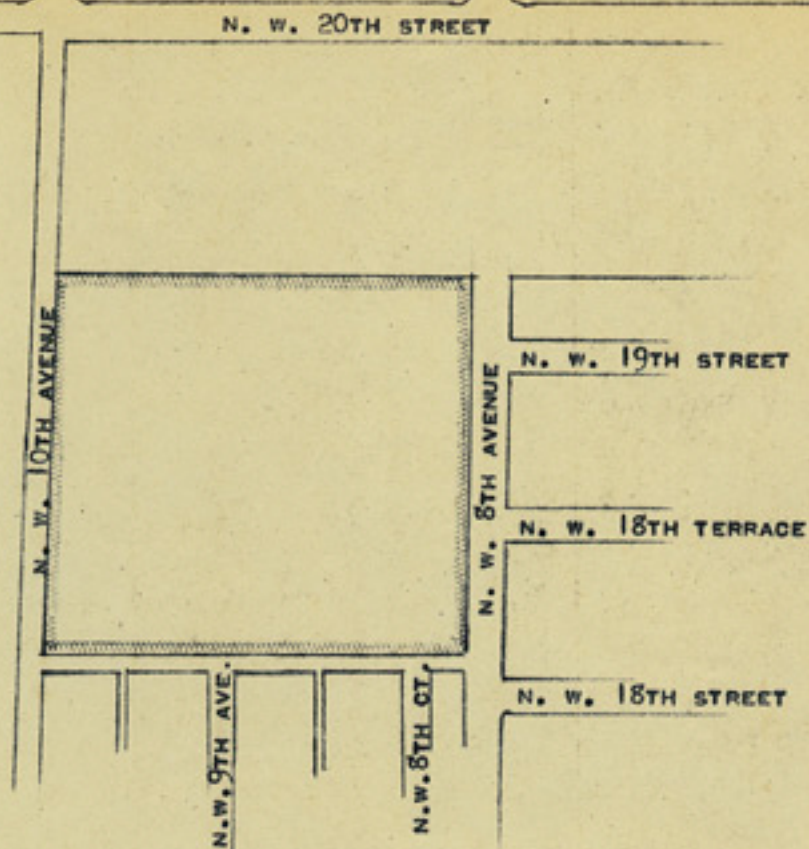
LOCATION PLAN

9 ACRES
 PLAYFIELD
 BASEBALL DIAMOND
 TENNIS COURTS (4 ASPHALT) FREE PLAY
 HANDBALL COURTS (6)
 BASKETBALL COURTS (2)
 SOFTBALL DIAMONDS (2)
 CHESS AND CHECKERS
 FOOTBALL FIELD
 COMMUNITY AND LIBRARY BUILDING
 COMFORT STATIONS
 LANDSCAPED - SHADE TREES - BENCHES
 CHILDREN'S PLAYGROUND
 WIRE FENCE ENCLOSURE
 SUPERVISED