

EDISON CENTER PARK 19.

POST WAR PLANS

ACQUIRE ALL PROPERTY FROM EASTERN BOUNDARY TO N. W. 4TH AVE.,
CLOSING ALL STREET DEDICATIONS.

THIS AREA CONSISTS OF ALL OF BLOCKS 1, 2, 3, 4, OF GORDON DALE
PARK SUBDIVISION.

CANCEL CLAUSE RESERVING NORTH 200 FT. OF PARK PROPERTY FOR
WATER TANKS.

REMOVE HIGH TENSION POWER LINE STRUCTURES FROM PARK PROPERTY.

A COMMUNITY BUILDING CONTAINING ASSEMBLY ROOM, MEETING ROOMS,
CHILDREN'S ARTS & CRAFTS, LOCKERS AND TOILET ROOMS.

A BANDSHELL AND OPEN AIR THEATRE WITH SHELTERS.

A RECREATION OFFICE, SHELTER HOUSE AND TOOL HOUSE.

MODERNIZE EXISTING COMFORT STATIONS.

A BATTERY OF 20 SHUFFLEBOARD COURTS, SHELTERS AND TACKLE ROOM.

ERECT A 10' CHAIN LINK FENCE AROUND EXISTING TENNIS COURTS.

COMPLETE THE THREE UNFINISHED TENNIS COURTS.

CONSTRUCT A BASEBALL DIAMOND IN THE N. W. CORNER OF THE AREA.

BUILD TWO ADDITIONAL SOFTBALL DIAMONDS, ONE WITH BLEACHERS.

INSTALL SPRINKLER SYSTEM AND DRINKING FOUNTAINS THROUGHOUT
THE WHOLE AREA.

INCREASE SIZE OF SHELTERS, PLAY AREA.

CREATE AN AREA IN THE SOUTHERN END OF THE PARK FOR ADULT RECREATION.

INSTALL FLOODLIGHTING OF A CAPACITY AMPLE TO LIGHT THE WHOLE AREA
AT ONE TIME.

(SEE "POLICING" UNDER MIAMI DIVISION OF PARK POLICE)

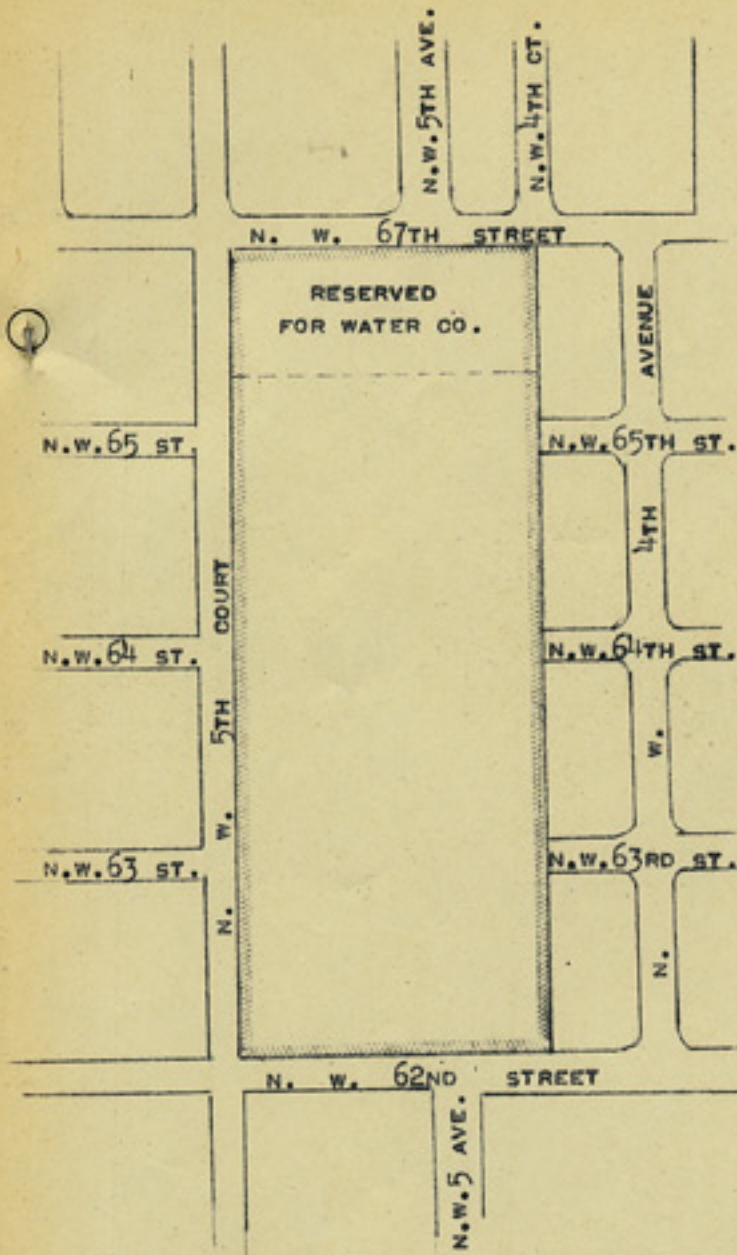

LOCATION PLAN

15 ACRES.

NEIGHBORHOOD PARK.

THIS AREA COMPLETELY ENCLOSED WITH WIRE FENCE, CLEARED AND ABUNDANTLY PLANTED WITH SHADE TREES TO PERMIT THINNING FOR FUTURE DEVELOPMENT.

THERE ARE THREE TENNIS COURTS, COMFORT STATION, SOFTBALL FIELD, CHILDREN'S APPARATUS AREA, TEMPORARY FIELD OFFICE, AND DRINKING FOUNTAINS. SUPERVISED.